

# Methodist Hospital Second Floor

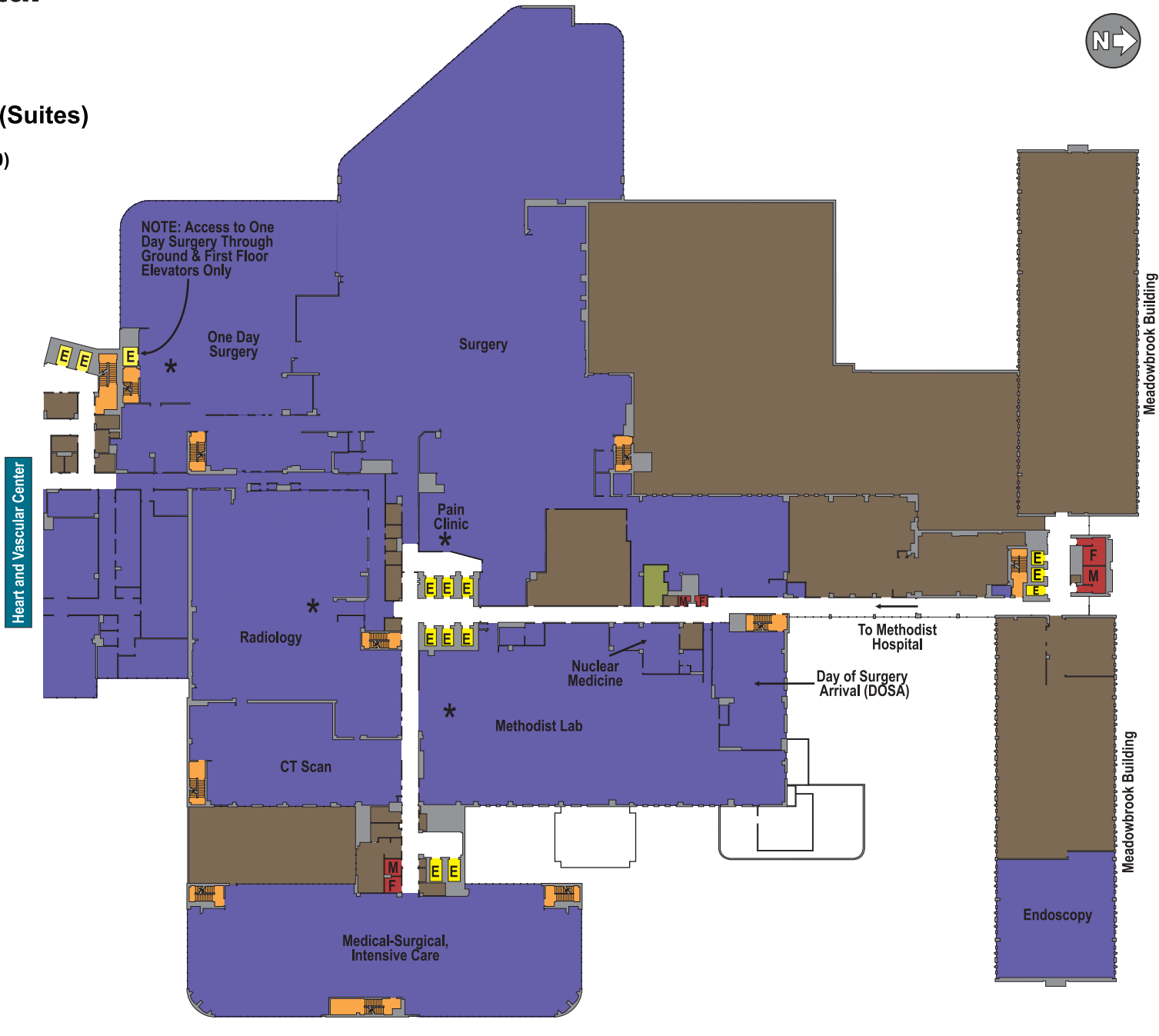

## Second Floor Destinations (Suites)

- CT Scan (2-380)
- Day of Surgery Arrival (DOSA) (2-300)
- Lab, Histology (2-480)
- Lab, Methodist (2-650)
- Medical-Surgical Intensive Care
- Nuclear Medicine (2-380)
- One Day Surgery (ODS) (2-750)
- Radiology (2-600)



## LEGEND

- |                         |                      |
|-------------------------|----------------------|
| PATIENT CARE AREAS      | SERVICE AREAS        |
| ADMINISTRATION          | RESTROOM             |
| COMMON AREA / HALLWAY   | OTHER                |
| ELEVATOR                | STAIRWAY             |
| PATH TO ONE DAY SURGERY | CHECK IN / RECEPTION |